

8
Floors

NIRVANA COUNTRY



100
Floors

ANANT RAJ ESTATE, SECTOR 63A



200
Floors

ESENCIA SECTOR 67

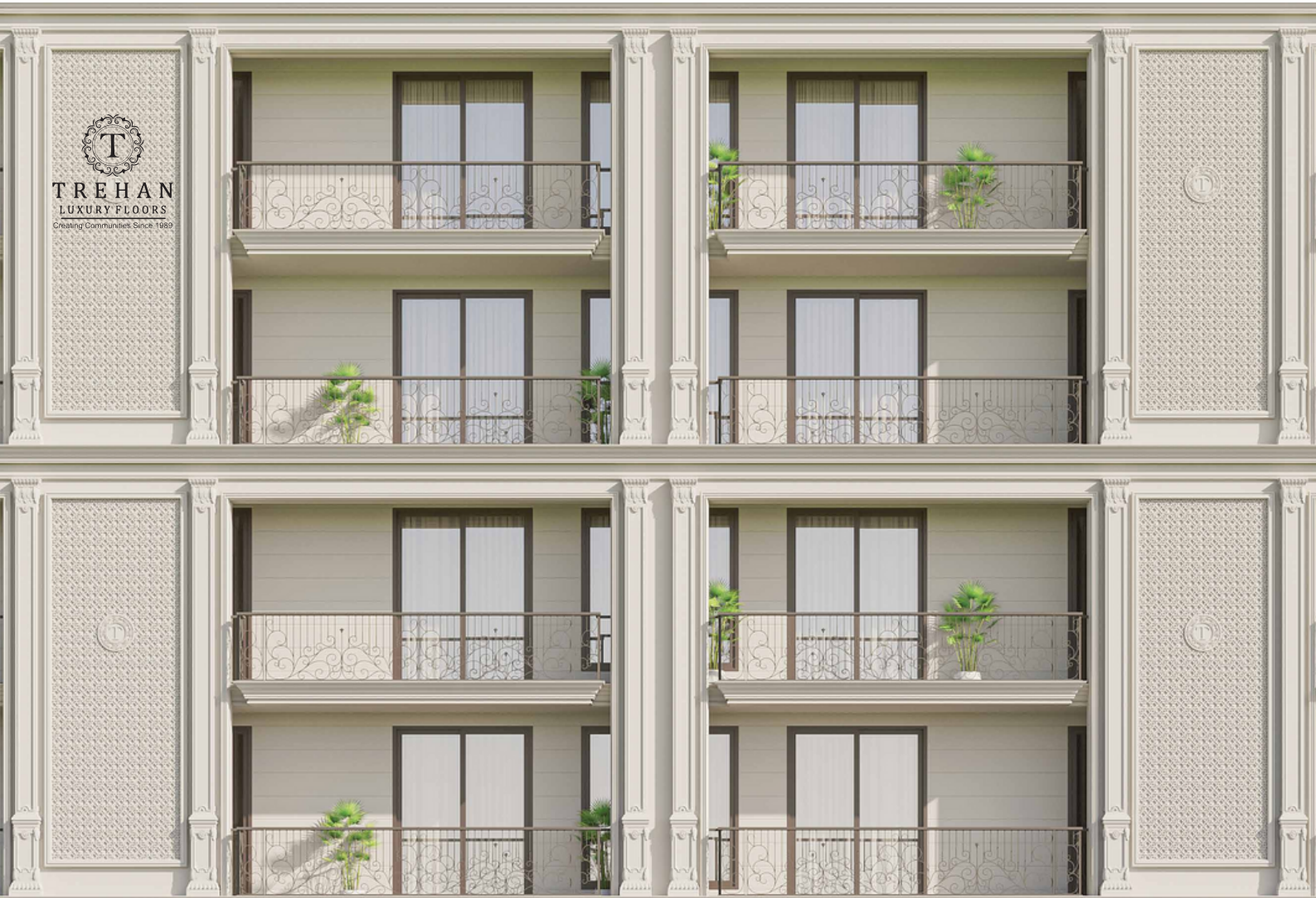

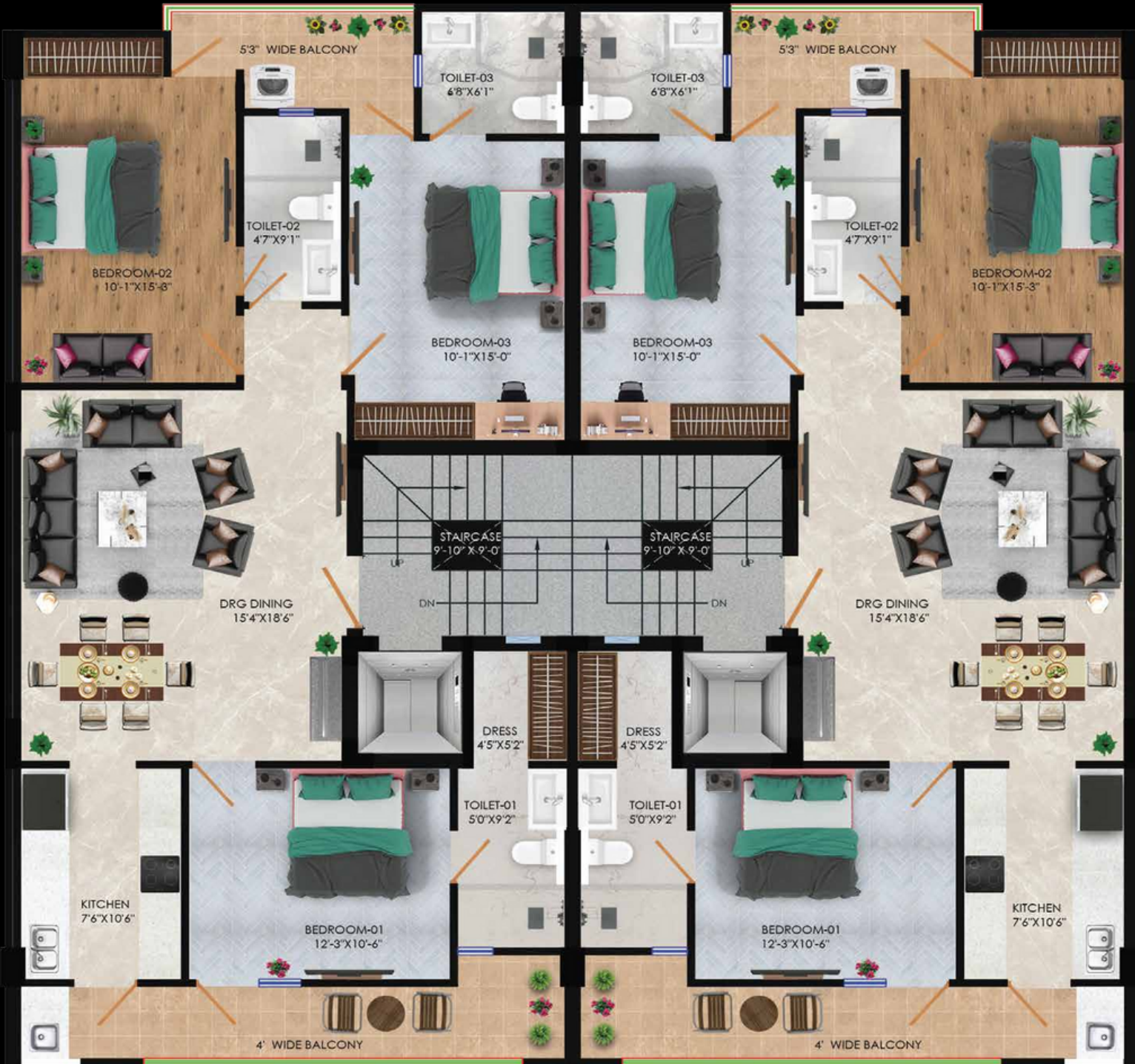

34 years
of excellence

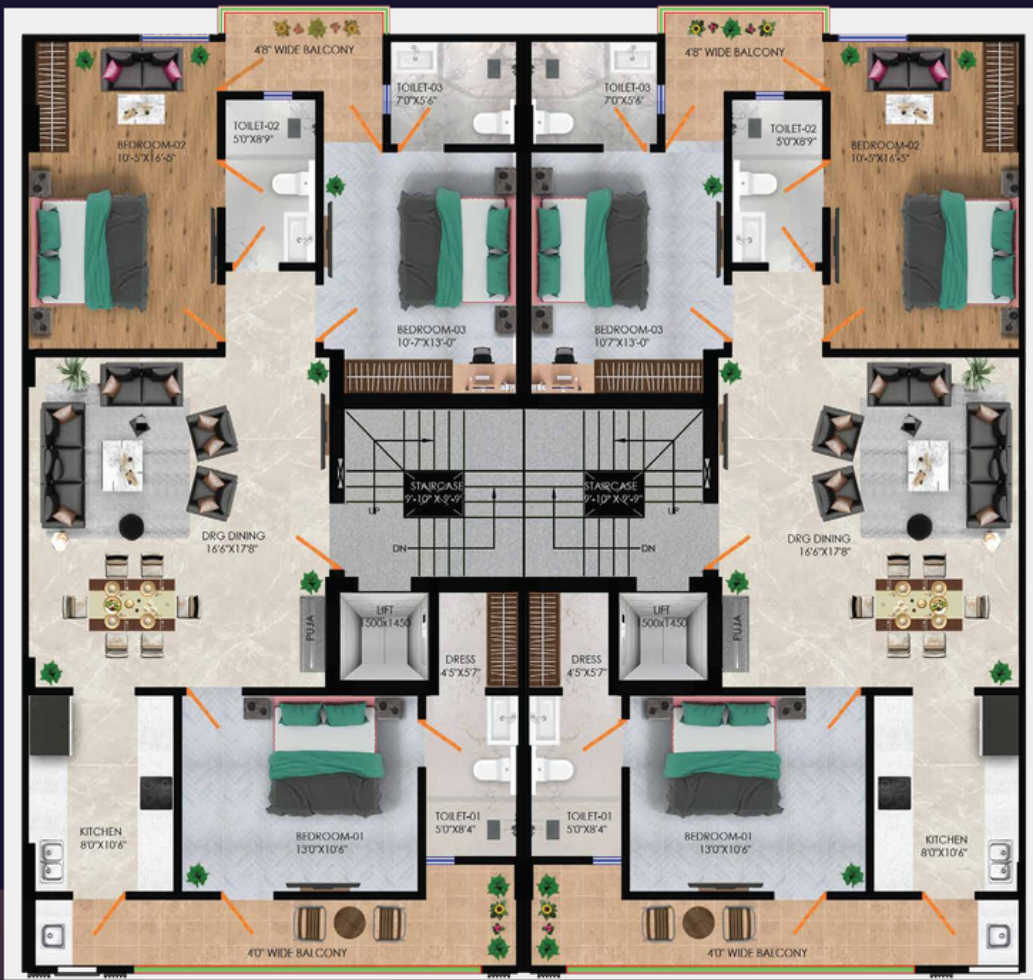

PRESENTING
SM ART
Elegant FLOORS
3 BHK

TYPICAL FLOOR
PLAN-A

HERE'S A CAPTIVATING GLIMPSE OF THE PROPERTY.



Anant Raj
Ashok Estate
in sector 63-A

TREHAN'S SMART HOME

A smart home that can be commanded with Voice, Remote & Mobile
 (Plots - A-11 to A18, A-190 to 197, A-199 to A-214, A-236 to A-243 & A-247 to A-248)

Trehan's Smart Home can be commanded with Voice, Remote and Mobile. It consists of Video Doorbell, Electric Lock, Sensors, Smart Lock, CCTV, Smart Curtains, Smart Lights, Background Music System and in-built Alexa.

Below is a brief description of the features: -

Main Entrance

Video Door Phone (With RF Card): - 4 Button Video Door Phone to contact each floor

individually. Visitors will press the specific floor bell and talk to the owner. The owner will be able to watch and talk to the visitor and unlock the main gate from a centralized Screen. Also, owners can open the main gate with RF card.

Electric Lock: - Electric lock at the main gate to prevent unauthorized access.

CCTV: - The stilt floor will be completely covered with 3 HD cameras with 24x7 recording up to 15-20 days.

Smart Automatic Light: - Elevation lights will turn ON automatically when it's dark and will turn OFF automatically when it's daytime. Helps in energy saving and unauthorized access.

Smart Movement Light: - Few lights of the stilt floor will be turned ON automatically when the movement will be detected. Helps in energy saving and unauthorized access.

Individual Floor

Smart Door Lock: - Highly Secure Smart Door Lock will allow owners to enter without keys. The door can be unlocked with a Fingerprint, Password, RF Card or even a manual key

Doorbell: - Additional regular doorbell at entrance

Smart Curtain: - Master Room will be equipped with a smart curtain that can be controlled through Voice, Mobile & Remote. Also, it can be scheduled to Open/Close automatically at a specific time.

Smart Lights: - Living Room & Master Room (Maximum 2 switches per room) will be controlled through voice, mobile and manual switches.

Background Music System: - 2 JBL Ceiling speakers along with a universal amplifier to play soft music or prayers using USB, Bluetooth, AUX & Alexa in the living room

Built-In Alexa: - Built-in Alexa in Living Room for controlling the entire home using voice

com-
mands.

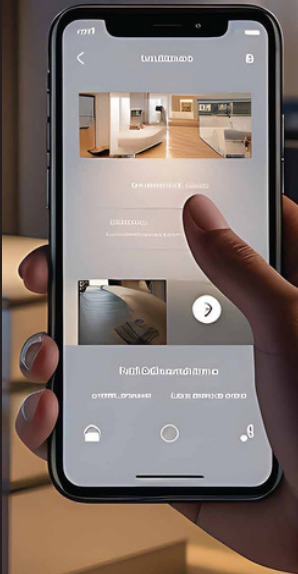

34 years of excellence



34 years of excellence

Elegant FLOORS

ANANT RAJ ESTATE











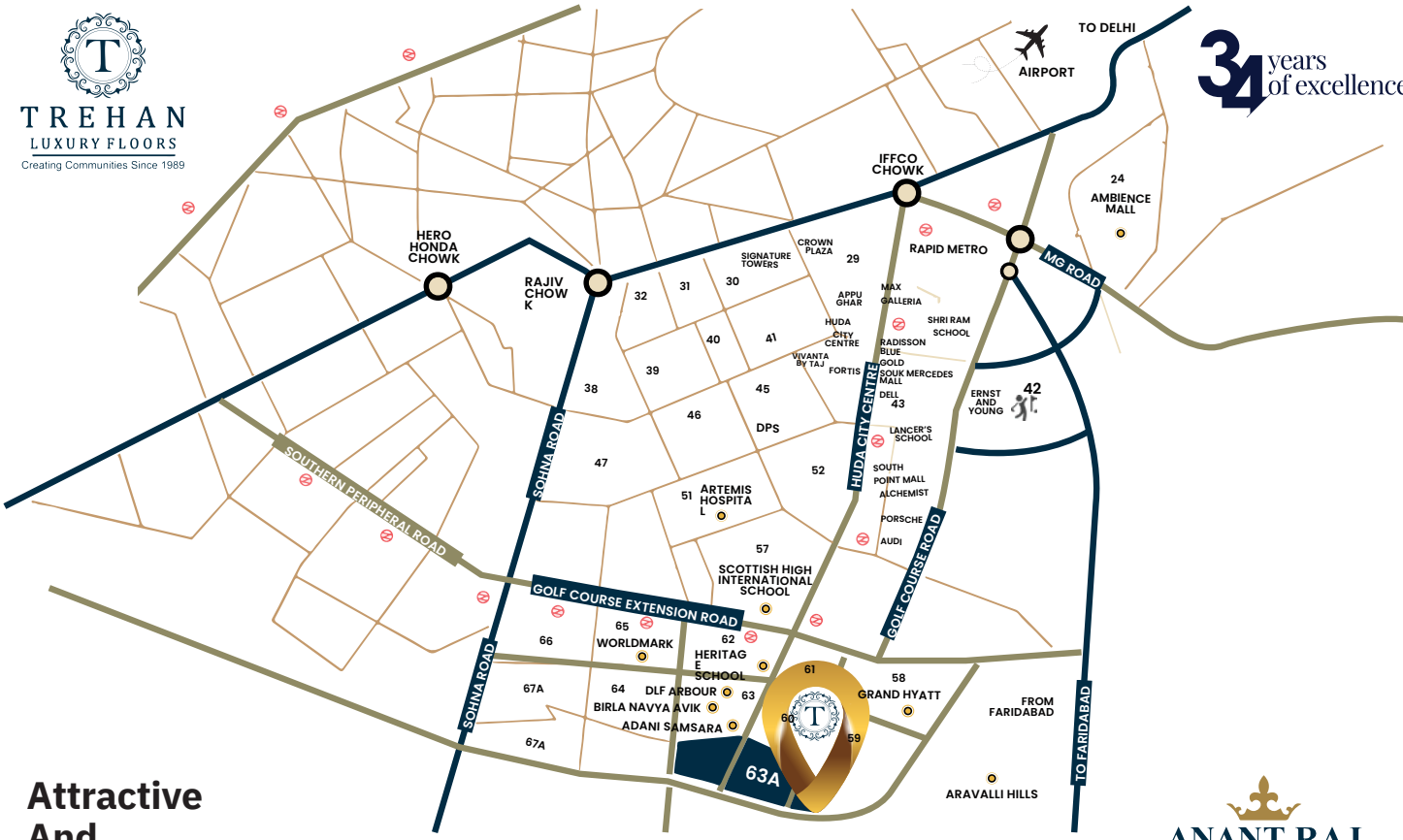

TREHAN
LUXURY FLOORS
Creating Communities Since 1989

31 years
of excellence



The map illustrates the strategic location of Anant Raj Estate (marked 63A) within a well-developed urban area. Key roads include Sohna Road, Golf Course Extension Road, and MG Road. Landmarks such as IFFCO Chowk, Airport, and various schools and hospitals are clearly marked, highlighting the estate's accessibility and amenities.

**Attractive
And
Advantageous
Location.**



**ANANT RAJ
ESTATE**



FEATURING 3BHK *Elegant* FLOORS
FOR A COMFORTABLE,
LUXURIOUS,
AND PERFECTLY DESIGNED LIVING EXPERIENCE.



*specifications subject to changes without prior notice

Trehan Home Developers Private Limited (THD) has been a real estate developer since 34 years and is one of the leading real estate developer especially in the residential sector.

The company has numerous successful constructions of housing and commercial projects in its portfolio at Gurugram, Delhi, Faridabad, Bhiwadi and Alwar. They have successfully helped 50,000+ families to get their dream home. The Group has been a real trendsetter when it comes to providing budget and affordable living keeping luxury in mind. Trehan provides an attractive concept of layout providing you a spacious home with great construction quality.

payment plan

25% booking
75% possession